



# 50mm HEAVY DUTY MAGNETIC CORE DRILL TYPE NW50 S

WASHER(3 OFF) 231.1.19  
SCREW(2 OFF) 602.1.25

STUD (4 OFF) 229.1.04  
NUT(4 OFF) 604.1.23  
WASHER(4 OFF) 231.1.19

COVER 278.1.74  
SCREW (3 OFF) 600.1.08  
SCREW (4 OFF) 601.1.28  
WASHER(4OFF) 606.1.07

INSULATION STAIPI(2 OFF) 500.1.40  
BRUSH HOLDER BLOCK (2 OFF) 500.1.39  
BRUSH HOLDER(2 OFF) 252.1.25  
CARBON BRUSH (2 OFF) 251.1.29

ARMATURE ASSEMBLY 832.3.23  
FLED ASSEMBLY 821.3.15

SCREW(2 OFF) 600.1.04  
WASHER(2 OFF) 231.1.17

BEARING 272.1.43

GREASE NIPPLE(2 OFF) 500.1.30  
GEAR PLATE 270.1.32

NUT 604.1.49  
KEY 275.1.79

GEAR 300.1.85  
BEARING 272.1.65

WASHER 606.1.03  
WASHER 235.1.24  
SHIM 322.1.26

WASHER 236.1.14  
CIRCLIP 311.1.26  
SPINDLE 290.1.78

SHIM 322.1.27  
WASHER 235.1.22  
BEARING 272.1.54  
BEARING 272.1.49

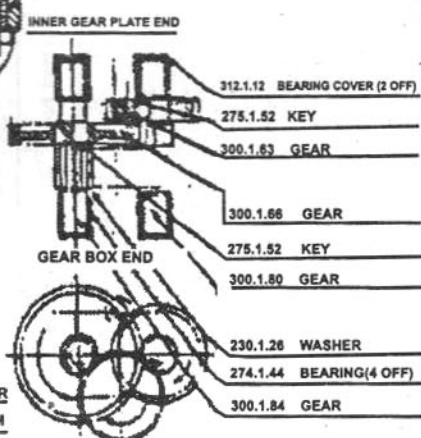
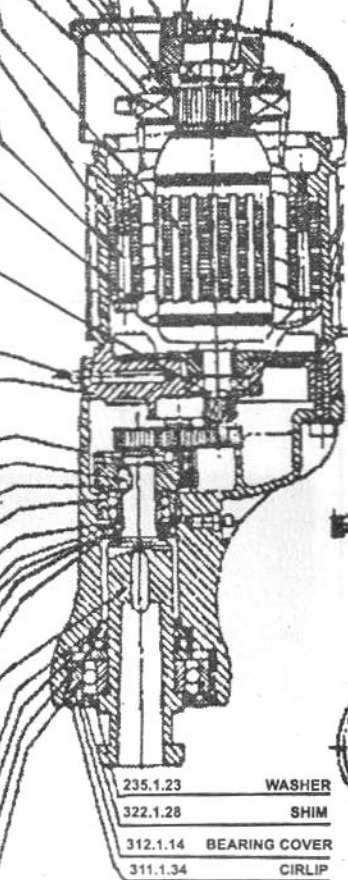
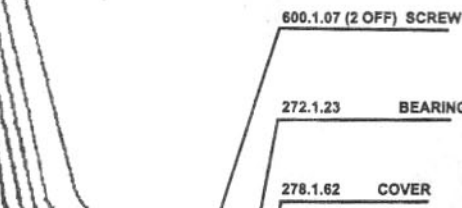
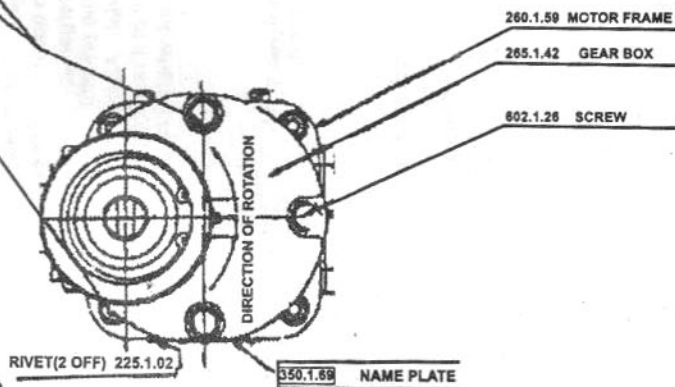

PIN 500.1.33 FITTED ON ASSEMBLY OFF FRAME & BRUSH HOLDER SUPPORT

- ITEMS NOT SHOWN
- 337.1.01 DRIFT
  - 500.1.33 PIN(2 OFF)
  - 500.1.42 PLUG(2 OFF)
  - 291.48 CABLE 3 CORE 48/20
  - 269.16 CONDUCT PIPE
  - 499.1.63 ELBO



- 310.1.36 SPRING
- 500.1.37 PLUNGER
- 500.1.38 PLUNGER CAP
- 500.1.31 BREAST PLATE
- 606.1.33 WASHER(2 OFF)
- 600.1.03 SCREW(2 OFF)
- 254.1.16 ROCKER(2 OFF)
- 601.1.29 SCREW(4 OFF)

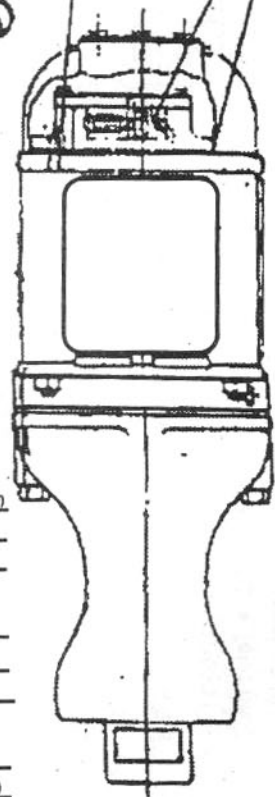

NOTE :  
1. BEARING (272.1.54) MUST BE ASSEMBLED AS FOLLOWS INNER WASHER WITH SLIGHTLY LARGER BORE TO BE