

For the best performance and prolonged tool life always use Ralliwolf cutting fluid and lubricants.



### COMMANDO 75

### Specifications

Model Number	Commando 75
Max. Capacity (Core/Broach Drilling )	75mm Dia x 75mm Depth
Max.Capacity (T.S Twist Drilling)	26mm
Watts Input (Full Load)	1800 Watts
No Load Speed	Low Gear : 70-180 r.p.m. / High Gear : 200-500 r.p.m
Spindle Bore	19.05mm (3/4") & 31.75mm (1 1/4")
Approx Net Weight	23.5 kg.

### Unique Features :

- For heavy duty operations the 'Commando 75' is a must for drilling larger holes.
- Compact, durable and more portable than other larger machines.
- Suitable for drilling up to 75mm diameter by 75mm depth.
- The 'Commando 75' offers forward and reverse functionality.
- The 'Commando75' can be supplied as a swivel base or a non-swivel option.
- The Commando range uses a unique dual motor protection system prolonging the machines life and preventing unwanted wear.

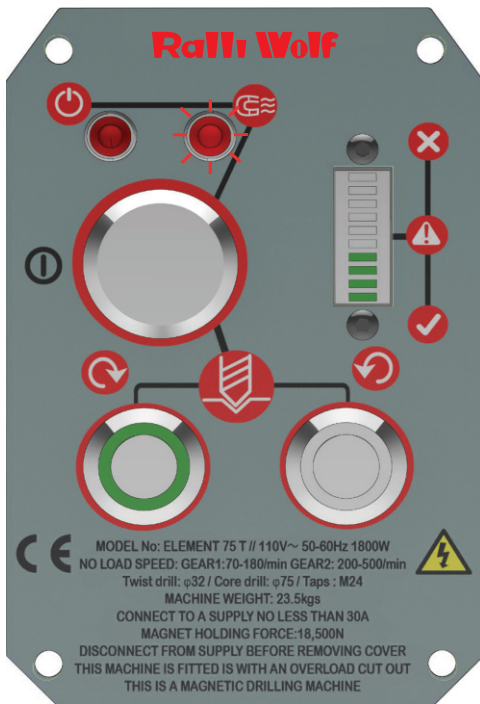

Red magnet LED - Indicates optimum adhesion not achieved. Drilling operation is still available but the red magnet LED makes the operator aware of a reduced magnetic strength.

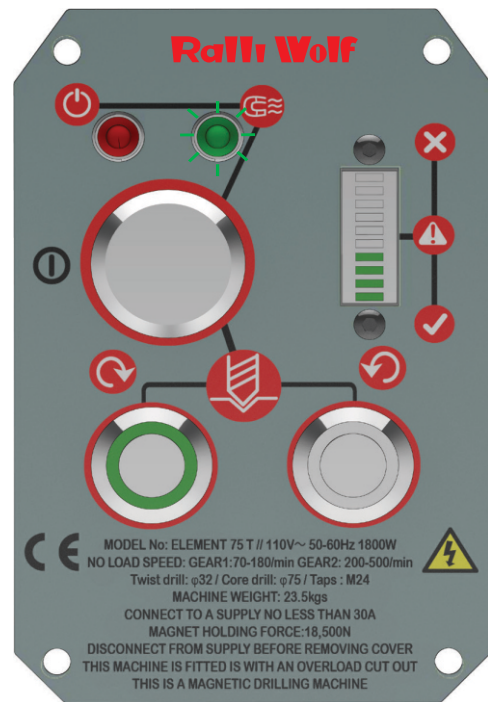

Green magnet LED - Drilling operation is available. This makes the operator aware of the optimum magnetic strength.

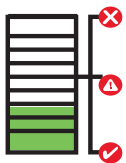

**Green Zone**  
 Perfect, try to keep in the green zone for the best cut and optimum machine performance.

The Commando range is fitted with Ralliwolf unique CutSmart™ panels designed to increase your tool life and productivity.



**Yellow Zone**  
 A little too much pressure on the drill, ease off to get back to the green zone.

Designed for you to get the most out of your machine and cutter. CutSmart™ has an easy to read panel that indicates when you are applying too much force avoiding inappropriate wear. Cutsmart™ allows the cutter to do the work and you will find that a much smoother hole and faster drilling time is achieved.



**Red Zone**  
 Overload: Back off immediately as too much force will cause the motor to cut off if you continue.

**Ralli Engineering Ltd.**

An ISO 9001:2015 Certified Organisation

**Regd. Office :**

4, Fairlie Place Kolkata - 700001 (India)  
 E : info@ralliwolf.com, P : +91 33 2262 7341  
 CIN : U51109WB1996PLC077080

**Sales Network :**

Ahmedabad, Bangalore, Baroda, Bhopal, Chennai, Cuttack, Coimbatore, Delhi, Guwahati, Jaipur, Jamshedpur, Jharsuguda, Kolkata, Ludhiana, Mumbai, Nagpur, Pune, Rajkot, Secunderabad, Trichy, Vishakhapatnam